

MUSC series

2/2 WAY N.C. PLUNGER TYPE DIRECT ACTING SOLENOID VALVE



Selection table



Seal material



Caution for safety
(Read before installing)



Specification

- IP65 waterproof coil. • Continuous cycle, 100% ED.
- Ex coil is EExm II T4 PTB approval.
- Response time: 03,06 ON: 5~20ms, OFF: 10~40ms
08,10 ON: 15~30ms, OFF: 30~60ms

Power consumption

Coil power	2	3	2E	4	5	3E
AC (VA)	6.9	8.0	5.3	18	24	8.6
DC (W)	6.0	6.8	5.2	15.0	18.5	10.0
Ambient temp.	-15~50°C (No freezing)					

Dimensions

Model	MUSC											
	03			06			08			10		
Code Dimension (mm)	2	3	2E	2	3	2E	4	5	3E	4	5	3E
L	25			30			40			42		
W	25	30	25	30	-			-				
H	58			62			86			87		
C	51			53			75			75		
D	18			23			31			31		
F	50			50			53			53		
M	M4			M4			M5			M5		
A	-			-			22			-		
N.W (kg)	0.17	0.21	0.44	0.22	0.25	0.48	0.50	0.58	0.79	0.52	0.60	0.81

Order example

* Standard port thread: Rc thread.
G and NPT thread please contact our sales.

MUSC-06-2-N-3-D-□-AC110

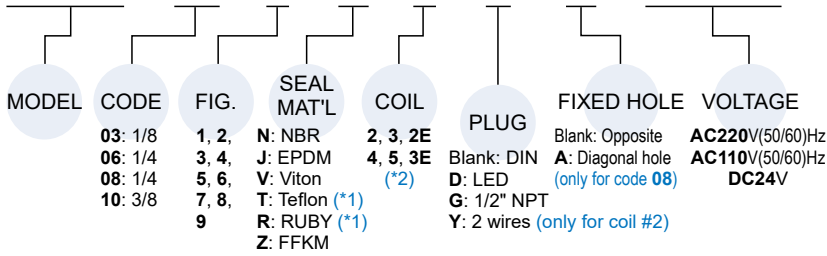

*1. When the seal material is (T) Teflon or (R) RUBY, the valve has slight leakage.
*2. Explosion-Proof (2E/3E) coil with LED (D) plug is not applicable.

Specification

Model **MUSC**: 303 S.S. body, for water, air, gas, light oil (50cst down), vacuum. 2/2 way N.C.

Code (Port)	Fig. no.	Seal mat'l	Coil	Orifice mm	Temp. °C						Working pressuer 0~bar						CV	VAC. torr
					Coil 2/2E			Coil 3			Coil 2		Coil 3		Coil 2E			
					N	JV	TZ	N	JVTZ	AC	DC	AC	DC	AC	DC			
03(1/8) 06(1/4)	1	N J V T Z	2 3 2E	1.0	-5 ~ 80	-10 ~ 80	-20 ~ 80	-5 ~ 80	-10 ~ 145	30	30	30	30	30	30	30	0.03	10 ⁻²
	2			1.3						30	24	30	30	30	30	0.05		
	3			1.6						30	20	30	30	30	24	0.09		
	4			2.0						16	11	22	20	17	14	0.14		
	5			2.5						10	7	12	10	10	8	0.18		
	6			3.0						6	4	8	8	7	5	0.27		
	7			3.5						4	2	8	6	5	4	0.30		
	8			5.0						1	0.2	2	0.5	1	0.1	0.40		

Code (Port)	Fig. no.	Seal mat'l	Coil	Orifice mm	Temp. °C						Max. O.P.D. bar (Min. 0 bar)						CV	VAC. torr
					Coil 4, 3E			Coil 5			Coil 4		Coil 5		Coil 3E			
					N	JV	TRZ	N	JV	TRZ	AC	DC	AC	DC	AC	DC		
08(1/4) 10(3/8)	1	N J V T R Z	4 5 3E	1.6	-5 ~ 80	-10 ~ 145	-20 ~ 160	-5 ~ 80	-10 ~ 145	-20 ~ 185	30	20	40	30	25	20	0.10	10 ⁻²
	2			2.0							24	14	30	28	16	12	0.15	
	3			2.5							17	10	24	20	10	8	0.20	
	4			3.0							10	6	16	13	7	6	0.31	
	5			4.0							8	4	12	8	4.5	3.5	0.54	
	6			5.0							6	2	9	5	2.5	2	0.80	
	7			5.5							4	2	7	4	2	2	0.95	
	8			7.5							2	0.8	3	2	1	1	1.10	
	9			10.0							0.8	0.4	1.6	0.8	0.4	0.4	1.30	

*1. Max. Orifice: 03/06 T=2.5mm, Z=3.0mm., 08/10 J=5.0mm, T=4.0mm, R=2.5mm, Z=5.0mm. *3. Connect air source to outlet port for vacuum application.
*2. Seal T and R might have below 300cc/min. slight leakage, so it is not suitable for vacuum.

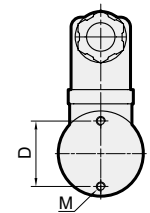
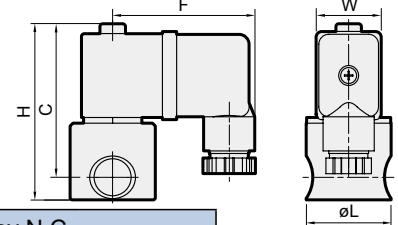

A
Diagonal hole

