

(TAC SERIES)

MVHA series Manual / Mech. Operator



HAND VALVE

mindman

Order example

MVHA – 34T

MODEL

Model	34T	34C	34CW	34B	34A
Shape					
Weight	20 g	15 g	15 g	15 g	28 g

34T

Fingertip operator



The 34T Operator may be used with any TAC series push-button valve to provide easier actuation.

Material
Level : Nickel-plated steel

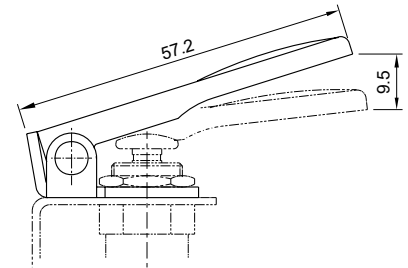

34C

Cam operator



The 34C Operator Cam-stroke is two times by the valve's push-stroke. Adjustment of roller height is made through the use of a mounting bracket and Locknuts.

Material
Level : Nickel-plated steel
Roller : POM

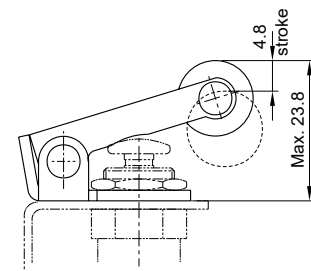

34CW

One-way cam operator



The 34CW Operator actuates valves when the pawl is contacted from lever side. The pawl then folds out of the way in the opposite direction.

Material
Level : Nickel-plated steel
Pawl : POM

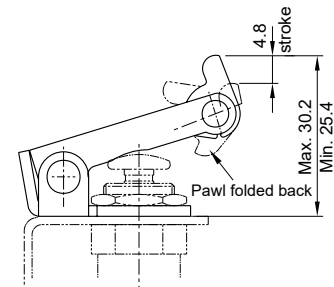

34B

Ball operator



The 34B Operator threads onto the collar of push-button valves. The mounting bracket thickness plus the washer thickness properly spaces the operator to prevent prestroking of button.

Material
Body : Nickel-plated brass
Ball : Chrome steel

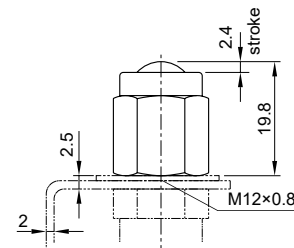

34A

Air pilot operator



The 34A Operator threads directly onto the collar of push-button valves. The air pressure applied to the pilot port drives piston to actuates the valve's push-button.

Material
Body : Nickel-plated brass

